



**DESTINATION
IMAGINATION.**

MASSACHUSETTS

2019-20 Massachusetts Region 7 Tournament

Medfield – 3/1/2020



WELCOME

Good luck to all teams competing in the tournament!

Thank you to all of the Team Managers, teachers, school sponsors, Appraisers, volunteers, and parents for your hard work to make this tournament possible.

Tournament Notes & Reminders

- Teams should report to their Challenge Prep Area 20 minutes before their scheduled Presentation time. (Engineering teams should report to Structure Check-In at least 1 hour before their scheduled Presentation time.)
- Spectators will NOT be allowed to enter the Presentation Area once a team's Presentation has begun.
- Info tables with schedules, maps and extra forms are located in the main entrances of both schools.
- Sales and Mini-Instant Challenges (open to all) will be located in the main entrance of the high school.
- Parents, spectators, and Team Managers: remember to respect the rules of Interference. Do not interfere with the team's solution.
- Team members, parents and spectators are responsible to know and adhere to the MADI Code of Conduct.
- Closing ceremonies will begin after the school is picked up. Please make sure all personal items are put back into your car or accompany you. We anticipate closing ceremonies to begin around 4:00pm and will take place in the high school gym.

Thank you to our sponsors!

Platinum Level



Silver Level



GIVING GROUP MA



Challenge A: The Big Fix

HS Media Center/Library

Central

Challenge	Team #	Team Name	Town	Manager(s)	IC Time	Level
10:40	119-70678	Medfield DI	Medfield	Wysocki	9:00	EL
11:00	119-13387	Big Bright Bold Brains	Foxboro	Towne	9:20	EL
11:20	119-31264	The Lava Puppies	Millis	Sugrue	9:40	EL
11:40	119-48413	Santa's Little Helpers	Franklin	Rosen	10:20	EL
12:40	119-69238	The Fantastic Five	Holliston	Donahue	10:40	EL
1:00	119-93880	Techy Tacos!	Sherborn	Littlefield	11:00	EL
1:20	119-18387	Cerebral Commotion	Ashland	Varadarajan	12:00	SL
2:00	119-58464	Brainstormers	Andover	Odden/Cox	10:40	ML
2:20	119-34299	Team Blossom	Holliston	T. Blossom	10:20	ML
2:40	119-18786	Holliston DI	Holliston	P. Baribeau	9:40	ML

Challenge B: First Encounter

MS Cafeteria

Central

Challenge	Team #	Team Name	Town	Manager(s)	IC Time	Level
9:00	119-35928	The Sixlets	Holliston	Eppinger/Griffith	12:20	ML
9:20	119-10150	The Golden Guys	Holliston	Morrison-Logan/Cornwell	1:40	ML
9:40	119-01042	The Package	Holliston	Hill	12:40	ML
10:20	119-57098	Jousting jabberwocks	Newton	McGuire	2:00	ML
10:40	119-93419	Holliston DI	Holliston	C. Baribeau	1:00	ML
12:00	119-93434	[redacted]	Holliston	J. Blossom	9:20	SL
12:20	119-07447	Rotisserie Gregzilas	North Andover	Abourjaily	1:20	SL
12:40	119-53120	DI Swirls	Holliston	Morrison-Logan	9:00	SL
1:20	119-96104	Foxboro Regional Charter School	Foxborough	Griesmer	12:00	EL
1:40	119-37612	The Pandas	Holliston	Ingoldsby	12:20	EL
2:00	119-90689	Pioneering Pandas	Wrentham	Cataldo	12:40	EL
2:20	119-26654	The Challengers	Holliston	McDaniel/Coughlin	1:00	EL

Challenge C: Picture This

HS Room 125

Central

Challenge	Team #	Team Name	Town	Manager(s)	IC Time	Level
9:40	119-77167	Holliston DI	Holliston	Gentile	1:00	SL
10:00	119-61664	Popcorn	Millis	Cassidy	12:40	SL
11:00	119-18197	Destination Imagination Youth	Dover	Correll	9:00	ML
11:20	119-55737	Razzle Dazzled Star-Nosed Moles	Franklin	Trull/O'Rourke	9:20	ML
11:40	119-08869	Medfield DI	Medfield	Barrette/Ryan	8:40	ML
12:40	119-19288	Medfield Madness	Medfield	Healy/Kenworthy	9:00	EL
1:00	119-68199	Smart Cookies	Holliston	Winston/Plante	9:20	EL
1:20	119-50795	Medfield DI	Medfield	Barrette/St. Mary	9:40	EL

Challenge D: To the Rescue (EL)

MS Lecture Hall

Central

Challenge	Team #	Team Name	Town	Manager(s)	IC Time	Level
8:40	119-83253	Galactic Monkeys	Sherborn	Semonian Eppich	11:20	EL
9:00	119-60773	The Bow and Arrows	Holliston	Lessard	1:20	EL
9:20	119-04363	119-04363	Franklin	Bheemu	1:00	EL
10:00	119-09053	The Top Hat Crew	Holliston	Harris/Schoenberg	12:40	EL
10:20	119-23103	Chili Dogs	Sherborn	Pion/Cordell	9:20	EL
10:40	119-61261	The Golden Phoenixes	Ashland	Tilak	2:20	EL
11:00	119-18126	The Fantastic Four	Medfield	Friedlander	2:00	EL
12:20	119-34052	The Guinea Pigs	Wrentham	Fisk	2:40	EL
12:40	119-50536	AA Sisters	Ashland	Maraliga	9:40	EL
1:00	119-52315	Dill Pickle Doodle Bobs of DS	Sherborn	Semonian Eppich	10:00	EL
1:40	119-53322	Intelligent Improv Peeps	Holliston	Javali	10:40	EL
2:00	119-31077	Fruit Snacks	Holliston	Brown/Dominquez	12:20	EL
2:20	119-78695	Mischief Marshmallows	Holliston	Eppinger/Peabody	11:00	EL

Challenge D: To the Rescue (ML & SL)

MS Auditorium

Central						
Challenge	Team #		Town	Manager(s)	IC Time	Level
9:00	119-13218	Weathaa!	Holliston	Schoenberg/Peters	11:20	ML
9:20	119-08106	Spicy Chickens	Holliston	Tremblay	1:00	ML
9:40	119-03741	Cool Legumes	Holliston	Rosen/Caruso	12:00	ML
10:20	119-07590	The Exotic NISVARs	Sherborn	Smedhall	12:40	ML
10:40	119-78057	Holliston DI	Holliston	M. Gentile	2:40	ML
11:00	119-20008	Too Good To Be True	Holliston	Dasari	1:20	ML
12:20	119-46147	Souper Squad	Franklin	Malatesta/Van Marter	2:00	ML
12:40	119-49450	Blue Mustaches	Sherborn	Atkins	2:20	ML
1:00	119-86781	Millis DI	Millis	Giardi/Gibbons	11:40	ML
1:40	119-38043	Wingin' It	Marstons Mills	Olsen	10:00	SL
2:00	119-85197	D-Irony	Wrentham	Hepburn/Duffy	10:20	SL
2:20	119-85386	Franklin DI	Franklin	Costa/Towle	10:40	SL
2:40	119-90677	Knock on Wood	Holliston	Harrington/Hurd	11:00	SL

Challenge E: It's in the Cards

HS GYM

Central							
Weigh In	Challenge	Team #	Town	Manager(s)	IC Time	Level	
8:40	9:40	119-24292	Medfield Makers	Medfield	McCarthy/Perschy	12:20	EL
9:00	10:00	119-99235	Five Guys on a Scooter	Newton	Stone/Bloch	12:40	EL
9:40	10:40	119-60003	The Mighty Duct Tapers	Medfield	Ehrenzeller/Ryan	1:00	EL
10:00	11:00	119-96291	Team Etc. III	Bellingham	Ormberg/Harris	2:00	EL
10:40	11:40	119-26913	Foxboro Regional Charter	Foxboro	Towne	1:20	EL
11:00	12:00	119-63155	Blue Lightning	Holliston	Logan/Logan	2:20	EL
11:20	12:20	119-07725	DI Dudes	Medfield	Puglia/Werner	2:40	EL
12:40	1:40	119-41791	The Wrentham Wiggly Worms	Wrentham	Milici	11:00	ML
1:00	2:00	119-88051	Millishoba	Millis	Unger/Jones	12:20	SL

Challenge PO: It's About Time

HS Media Center/Library

Central						
Challenge	Team #		Town	Manager(s)	IC Time	Level
8:40	119-22206	DI Divas	Medfield	Kenworthy/Crocker	10:00	EL
9:00	119-98909	Joe's BBQ and Foot Massage	North Andover	Abourjaily	10:20	EL
9:20	119-63670	The Flying Bacon Bits	Holliston	Brown/Henson	11:20	ML

Challenge RS: Blast Off!

MS Gym

Central						
Challenge	Team #		Town	Manager(s)	IC Time	Level
10:00	119-30367	Team Cosmos	Medfield	Puglia/Wolfstich	8:40	RS
10:20	119-28423	Team Rocket	Holliston	Cummins	9:00	RS
10:40	119-01008	Wrentham Imagination	Wrentham	Anderson	9:20	RS
11:20	119-26497	Screen Hawks	Millis	Kepple/Randa	10:00	RS
11:40	119-05708	Awesome Red Flaming Balloons	Holliston	Dominguez/Winston	10:20	RS
12:00	119-72318	The ScientificTrying Elephants	Millis	Tufts	10:40	RS

Notes:

Thank you to our sponsors!

Platinum Level



Silver Level



GIVING GROUP MA

Picture This:
 Performance - 125
 Prop Storage - 126

In the Cards:
 Check in - 119
 Prop Storage - Hallway
 Performance - Gym

It's About Time &
 The Big Fix:
 Prop Storage - 120
 Performance - MC/Library

Info/Sales/IC for All - Main Entry
 Medical Official - Nurse's Office
 Pictures - 123

IC Entrance - Main Entry
 IC Exit - Stairwell near 119
 Manager's Lounge - 117

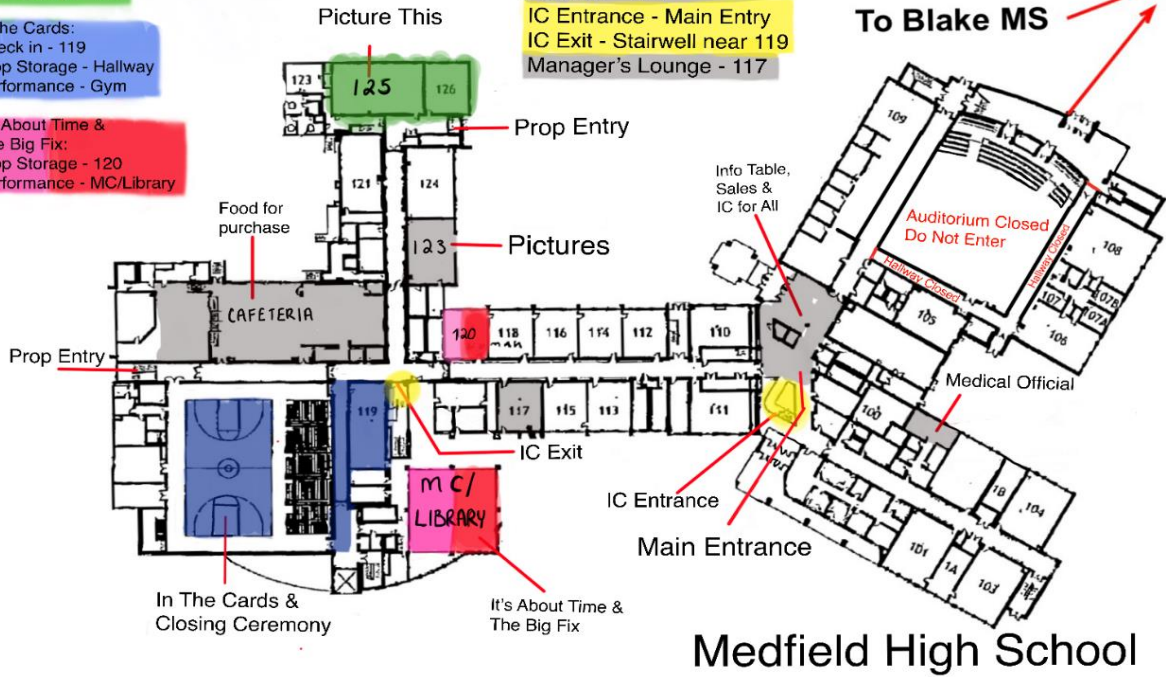

Blake Middle School

Blast Off!
 Prop Storage - Hallway
 Performance - Gym

First Encounter:
 Prop Storage - 404
 Performance - Cafeteria

To The Rescue:
 Prop Storage - Hallways
 Performance EL - 408
 Performance ML/SL - Auditorium

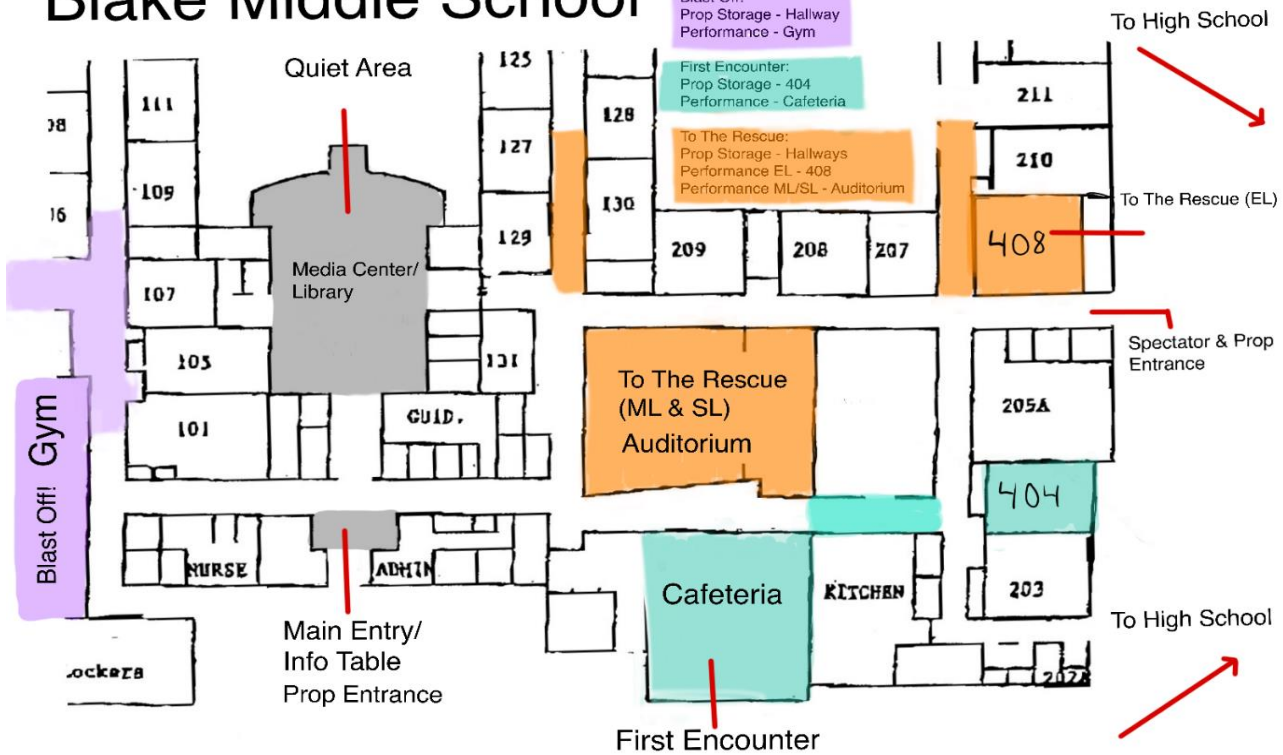

Medfield Dining Services

Items available for purchase in the high school cafeteria

Breakfast

Bacon, Egg & Cheese Breakfast Sandwich - \$3.00
Chocolate Chip Muffins - \$2.50
Blueberry Muffins - \$2.50
Yogurt Parfaits - \$5.00
Granola Bars - \$1.50 - \$2.00

Lunch

Cheese Pizza - \$15.00
Pepperoni Pizza - \$16.00
Cheese Pizza Slice - \$3.00
Pepperoni Pizza Slice - \$3.25
Chicken Fingers & Fries - \$7.00
Grab 'n' Go Salads - \$6.50
Grab 'n' Go Sandwiches - \$6.50

Beverages

Coffee - \$2.00
Tea - \$1.50
Hot Chocolate - \$2.00
Bottled Water - \$1.50
Seltzer Water - \$2.00
Soda - \$2.50



Release/Disclaimer

By my participation in an event conducted by an Affiliate, Region, or other gathering related to the Destination Imagination program, the participant or participant's parents or participant's guardian understands and hereby voluntarily agrees to release, waive, forever discharge, hold harmless, defend, and indemnify Destination Imagination, Inc. and its agents, officers, boards, volunteers, and employees from any and all liability and all claims, actions, or losses for bodily injury, property damage, wrongful death, loss of services, or otherwise which may arise out of the participant's participation in activities related to the Destination Imagination event, including travel to and from the event.

MADI Code of Conduct Form

Applicable to: Team Member * Parent * Relative * Sibling * Friend * Official * General Spectator

KNOW THE MADI RULES

Our Tournaments will be a positive, safe and fun experience for all if:

1. Responsible adults supervise all minors (team members & siblings).
2. Everyone respects and obeys any signs inside or outside the building.
3. Everyone respects all property, including lockers, displays, classrooms, and grounds.
4. Everyone keeps all food & drink in the designated areas of the site.
5. Everyone knows Prop Areas are used as storage areas only for the teams that are competing.
6. Everyone knows electrical outlets are "off limits" for everyone (unless otherwise specified in a challenge).
7. Everyone knows that glue guns, power tools, and anything that could cause damage are not allowed in the Tournament Site.
8. Everyone knows all materials (like make-up) are carefully used without leaving stains.
9. Everyone acts in a safe manner: no running, climbing, throwing (even balls) & rough housing.
10. Everyone demonstrates good sportsmanship. Rudeness, name-calling, insults, profanity or asking others about scores does not happen.

WHAT IF YOU BREAK THE MADI RULES?

EVERYONE at our tournaments will be held accountable for his/her behavior.

ANYONE not following the above rules may cause a team to receive a penalty and/or disqualification.

REALIZE that your behavior may negatively impact the team you are here to support—act positively to support "your" team

KNOW THE RULES of INTERFERENCE

Our teams will have the opportunity to experience "DI" and learn more if:

1. Everyone knows that only the team can assemble, prepare, or repair props.
2. Everyone knows that only the team can apply makeup, work on hairdos, costumes, etc.
3. Everyone knows that only the team can work on props, costumes, directing, and staging.
4. Everyone knows that all the research, ideas, and solutions are those of only the team members.
5. Everyone knows that only the team members will answer the questions of the prep appraiser and the challenge appraisers.
6. Everyone knows that paperwork is completed by the team. (Rising Star and Elementary teams may have their manager script their words.)

CONSEQUENCES OF BREAKING THE RULES of INTERFERENCE

EVERYONE has a role in helping to enforce the Rules of Interference: See Something, Say Something.

ANYONE not following the above rules may cause a team to receive a penalty and or disqualification.

Your actions can impact the team you are here to support.

Our tournaments must be a positive, safe and fun experience for all.

Our host sites must be left in great shape & the staff knows we appreciate the use of their space.

Our teams must get as much out of the "DI" experience as possible.

These rules will be in effect at all Massachusetts Destination Imagination tournaments.



Vision

Inspire and equip participants to achieve anything they can imagine in life

Mission

To engage participants in project-based challenges that are designed to build confidence and develop extraordinary creativity, critical thinking, communication, and teamwork skills

New to DI? Welcome!

We're glad you're here! There's no better way to understand the Destination Imagination Challenge Experience than to see it in action. To get the most out of your day at this tournament, here's what we suggest:

- Attend at least one Presentation in every Team Challenge. Each Team Challenge is unique and has open-ended requirements, allowing teams to create totally different solutions from one another. Read through the Points of Interest so you know what you can expect to see. Each Presentation is around eight minutes in length.
- Wish the teams luck in their Instant Challenge. All of our teams participate in an Instant Challenge as part of their tournament experience, during which they use quick, creative and critical thinking, and teamwork to come up with a solution in a short amount of time. Spectators are not allowed in these presentations as the Instant Challenges themselves are highly confidential.
- Look at the props, costumes, sets, technical devices and more that the teams have created—but please don't touch! Remember that everything you see was crafted by the team members with no adult Interference.
- Talk to teams, parents and volunteers about their experience with this season of Destination Imagination. Tell them you're considering starting a team, and ask them to share their favorite thing about DI—you'll be amazed by the different answers you hear.
- Have fun, be inspired, and imagine the possibilities!

Learn more at DestinationImagination.org. Sign up for our newsletter for all the latest updates and to be alerted when registration is open for the 20-21 season.

Learn more at DestinationImagination.org

2020-21 CHALLENGES

